

Diesel Spin-On Series

Models 215R, 230R, 245R

1

SPECIFICATIONS are found on Spin-On Series introduction page.

Note: to order a unit with metric threads, specify an asterisk (*) in front of the part number.

230R	M	P	12	2
215R= 15 GPH 230R= 30 GPH 245R= 45 GPH	<u>Metal Bowl.</u> Add 'M' (Omit if not desired)	<u>Water Probe.</u> ¹ Add 'P' for an in-bowl water probe. (Omit if not desired)	200 watt Electric Heater. ² Specify: '12' for 12 vdc or '24' for 24 vdc in-bowl heater. (Omit if not desired)	<u>Element Filtration Rating.</u> Specify one: '2', '10' or '30'
¹ Head fuel ports are 1/4"-18NPT (SAEJ476). Includes in-head primer pump. ² Must be used with Water Detection Kit -See Accessories Section. ² Recommended for use with Racor Relay Kit -See Accessories Section.				

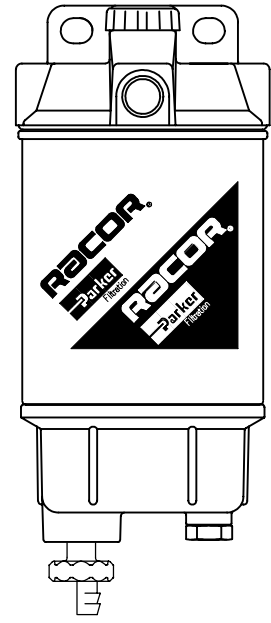

245R shown

Replacement Service Elements 12/Case -Seals included.

Model	Final Filtration	Secondary Filtration	Primary Filtration*
	2 Micron	10 micron	30 micron
215R	R15S	R15T	R15P
230R	R20S	R20T	R20P
245R	R25S	R25T	R25P

*A secondary/final filter is required downstream.

Performance Graphs

-These results are from controlled laboratory tests. Field results may vary by application.

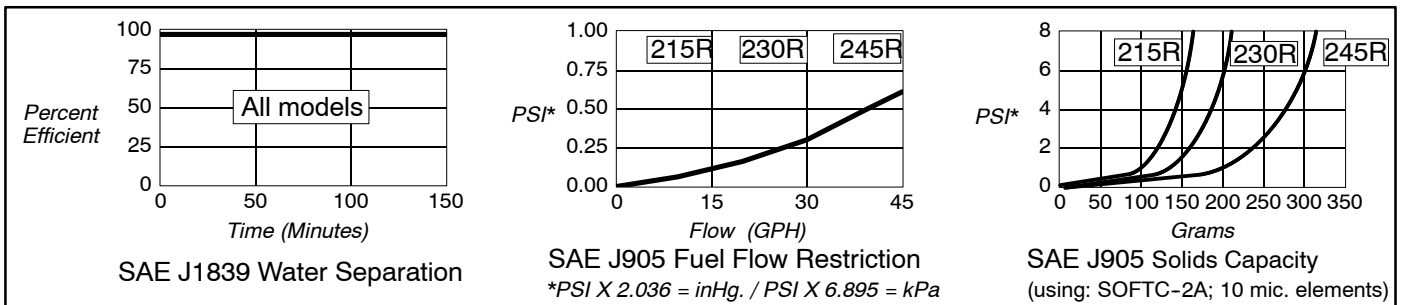

Mounting Pattern / Parts List

-The circled number corresponds to the item number shown below.

5/16" (8 mm) diameter clearance for fasteners.

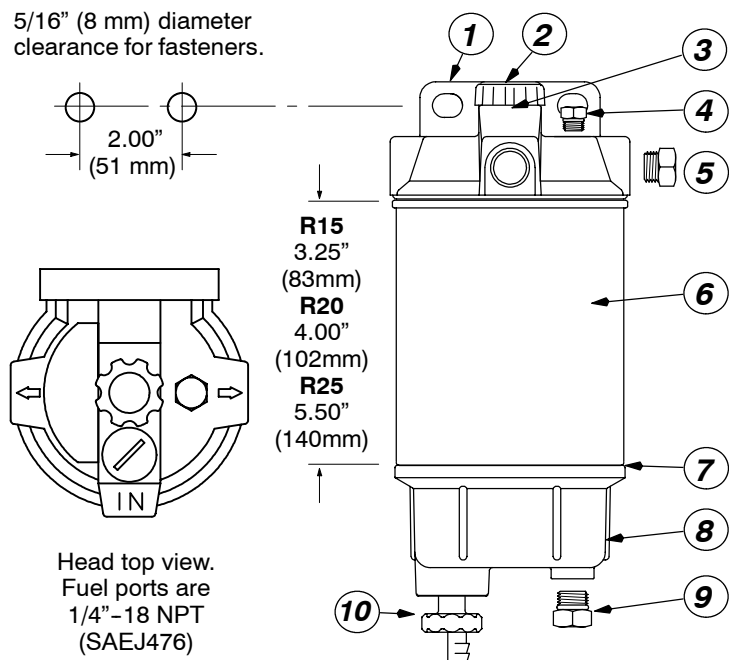

Item/Part No.	Description	Case Qty.
1 RK20046	Head, 1/4"-18 NPTF Ports	1
RK20049	Head, 14 mm X 1.5 Metric ports	1
2 RK20025	Primer Pump Assembly	1
3 RK20011	Check Ball and Plastic Cap	1
RK20742	Metal Check Ball Cap	1
4 RK10110	Metal Vent Plug, 3/8"-24 SAE	1
5 RK12041	Metal Port Plug, 1/4"-18 NPT	1
6	See 'Replacement Service Element' box above.	
7 RK22244	Bowl O-ring	20
8 RK22350-02	See-thru Bowl Assembly w/ Plug	1
RK22354-01	12vdc Heater and See-thru Bowl	1
RK22354-02	24vdc Heater and See-thru Bowl	1
RK30499-01	12vdc Heater and Metal Bowl	1
RK30499-02	24vdc Heater and Metal Bowl	1
RK30876	Heater Connector Replacement	1
RK22368	Metal Bowl (drain/probe ports)	1
9 RK20022	Metal Plug, 1/2"-20 SAE	1
RK20126	Plastic Plug, 1/2"-20 SAE	1
RK30964	Water Probe/Connector(not shown)	1
10 RK30476	Self-venting Drain Kit	1
RK20075	Complete Gasket/O-ring Kit	1
22360	Installation Instructions, 200 Series	

¹ Must be used with a Water Detection Kit -See Accessories.

Diesel Engine Spin-On Series

Service Elements

See facing page for optional mounting heads and contaminant collection bowl kits.

All Racor replacement service elements meet OEM specifications.

Bowl supplied with part numbers that have a 'B' prefix. No water probe port on bowls.

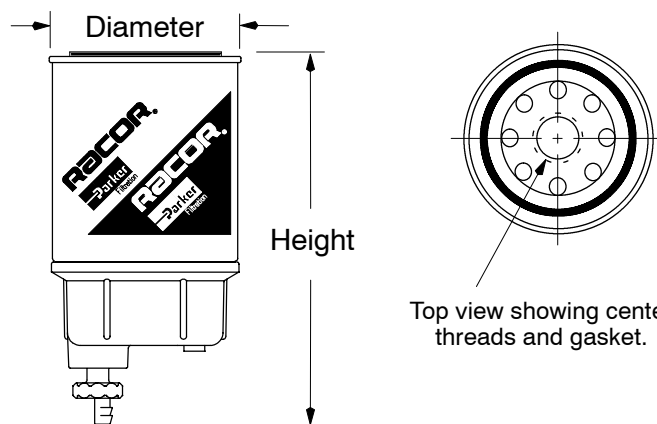

Specification/Cross Reference Chart

Filter & Bowl	Filter only	Height in./mm	Diameter in./mm	Center threads	OEM	AC	Baldwin	Fleetguard	Fram	Purolator	Wix
B32001	S3201	10.50/267	3.82/97	1"-14	Cum 138627 Cum154709 Cum 202893 Cum 156172	TP-619 TP-629 TP-972 TP-811	BF-948 BF-948D BF-957 BF-957D BF-7557	FS1212 FF104 FF105 FF105C /D FF213	P1101PL	PER15 6683776 PER23-1 PER23-2 6694036	33107
B32002	S3202	10.50/267	3.82/97	1"-12	DDA6438839	T-815 T-915	BF-580	FS1213 FF207	P1146	PER96	33118
B32003	S3203	8.63/219	3.82/97	1"-14	Cat 6L7440 Cat 1P2299 Cum138627 IH625627C1	TP-877 TP-619	BF-970 BF-957 BF-979	FF5020 FS1214 /15 FS1212 /25 FS185 /04	P1104 P1101PL P1118	PER53 PER15 PER39 PER35	33352 33107 33341
B32004	S3204	7.13/181	3.82/97	1"-14	IH625625C1	TP-807	BF-984	FS1220 FF196	P1117 P3767	PER35	33239
B32005	S3205	9.75/248	4.38/111	13/16" -18	Mack 483GB219A	TP-635	BF-877	FS1219 FF172	F1109	PER31	33219
B32006	S3206	12.00/305	4.38/111	1"-14	Cat4N5823	TP-920	BF-584	FS1218 FF211	P3376	PER85	33384
B32007	S3207	13.50/343	5.09/129	1 1/4" -12	Cum299202	TP-917	BF-596	FS1216 FF202	P3430	PER134	33116
B32008	S3208	7.25/184	2.85/72	16mm Add suffix letter: X 1.5, S=2 micron, T=10 micron, P=30 micron, 30 GPH/114 LPH, 12/Case	Deutz Q1H4117 Volvo 243004	TP-961	BF-993	FF1221 FF202	P4102	PC-42	336P 33195
B32009	S3209	8.63/219	3.82/97	16mm Add suffix letter: X 1.5, 72mm gasket	Mann WK962/4 DAF 247138			FF4070	P4107	PC-45	33449
B32011	S3211	8.63/219	3.82/97	1"-14	Cat 6L7440 Cat 1P2299 Cum138627 IH625627C1	TP-877 TP-619	BF-970 BF-957 BF-979	FF5020 FS1214 /15 FS1212 /25 FS185 /04	P1104 P1101PL P1118	PER53 PER15 PER39	33352 33107 33341
B32012	S3212	7.13/181	3.82/97	1"-12	GM/DDC 8.2L, 30 micron, 90 GPH, 12/Case	TP-936	BF-592	FF235	P3594	PER227F	33121
B32016	S3216	5.85/149	2.85/72	16mm Add suffix letter: X 1.5, 72mm gasket							33392
B32022	S3222	10.50/267	3.82/97	1"-14	Thermo King Primary Filtration				PS7210		
N/A	S3229	10.23/260	3.82/97	1"-12	10 micron, 90 GPH, 12/Case						

(Specification/Cross Reference Chart continued on next page)

Specification/Cross Reference Chart (continued)

Filter & Bowl	Filter only	Height in./mm	Diameter in./mm	Center threads	OEM	AC	Baldwin	Fleetguard	Fram	Purolator	Wix
B32030 S3230 Application: Blue bird, 30 mic., 60 GPH, 12/Case		8.63/219	3.82/97	1"-14	4309159						
B32033 S3233 Application: 2 micron, 60 GPH, 12/Case		7.50/191	4.25/108	7/8"-14"	Cat 9Y4425	TP862	BF588	FF182	P1107	6680518	33237

FUEL FILTER MOUNTING HEADS

The mountable filter heads shown below may be used with many of the diesel engine spin-on series fuel filter/water separator elements listed on the next page. Follow the table for selection.

Head Part No.	Center Threads	Inlet / Outlet	Vent Port	Use With the Following Units
RK30287	1"-14	7/8"-14 SAEJ1926 O-ring Boss Ports	Not Available	B32001/S3201, B32004/S3204, B32011/S3211, B32003/S3203, B32006/S3206, B32022/S3222
RK31547	1-1/4"-12	7/8"-14 SAEJ1926 O-ring Boss Ports	3/4"-16 SAEJ1926 O-ring Boss Ports	B32007 / S3207

RK30287 Filter Head, Fasteners and Mounting Bracket

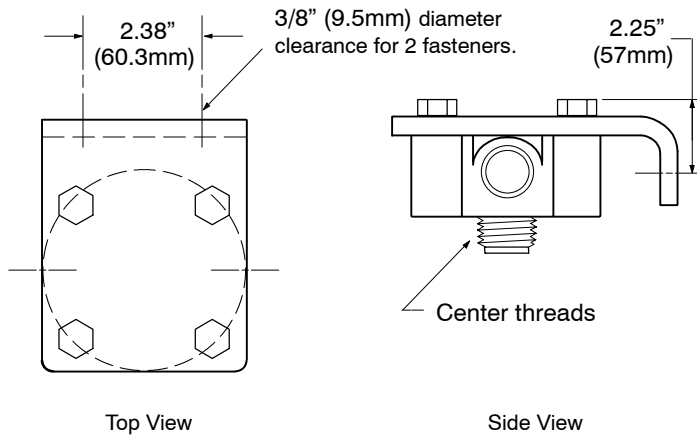

RK31547 Filter Head/Mounting Flange (not to scale)

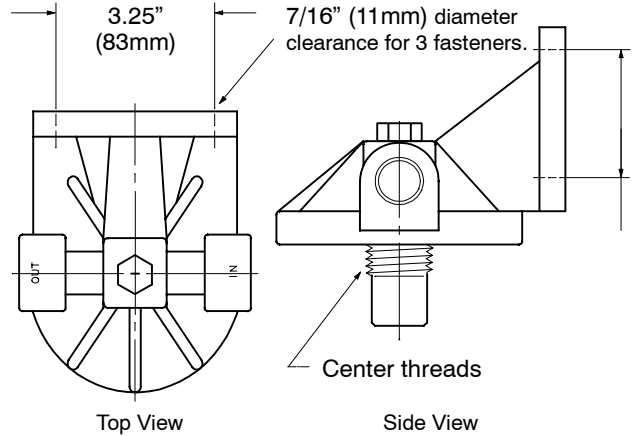

FUEL FILTER COLLECTION BOWLS

These spin-on, reusable contaminant collection bowls shown below may be used with many of the diesel engine spin-on series fuel filter/water separator elements listed on the next page. All bowls feature a water probe port unless noted.

See-thru Non-Heated Replacement Bowl Kits:

- RK10215 for 2.85" diameter filters (see style A).
- RK30051 for 3.82" diameter filters (see style C).
- RK30063 for 4.38" and 5.09" diameter filters (see style D).

See-thru Heated Replacement Bowl Kits:

- RK30895* for 3.82" diameter filters, 12 vdc, 200 watt (see style C).
- RK30924* for 3.82" diameter filters, 24 vdc, 200 watt (see style C).
- RK30900 for 4.38" and 5.09" diameter filters, 12 vdc, 200 watt (see style D).
- RK30925 for 4.38" and 5.09" diameter filters, 24 vdc, 200 watt (see style D).

Metal Non-Heated Replacement Bowl Kits:

- RK10109 for 2.85" diameter filters, non-painted (see style B).
- RK30745-01 for 3.82" diameter filters, painted beige (see style C).
- RK21640 for 4.38" diameter filters, non-painted (see style D)

* Does not feature a water probe port.

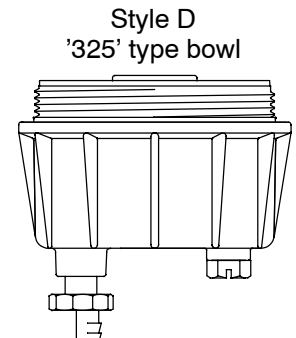
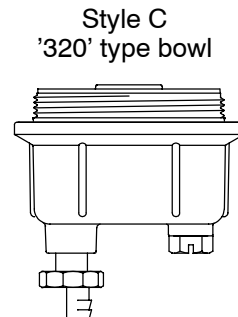
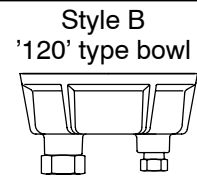
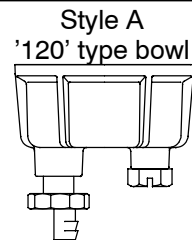

Model Illustrations

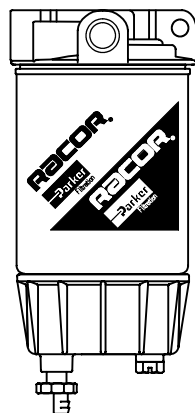

325R



330R

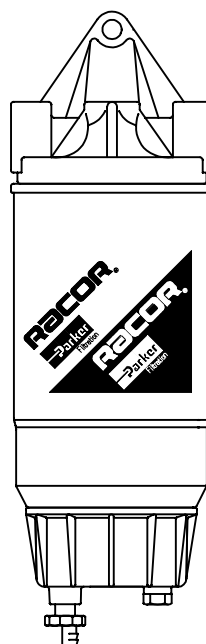

3150R

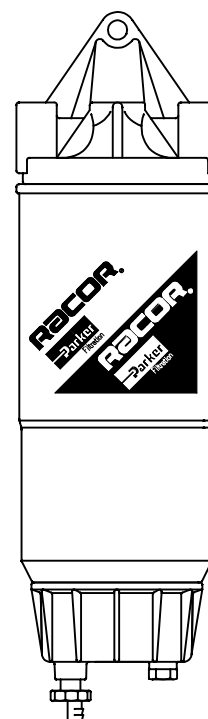

3250R

Special Notes

1. The 325R/330R models are standard with a 12 vdc,150 watt heater. Options include a Water Probe and Element Restriction Detection Kit which alerts the operator when water must be drained or element restriction reaches 7 inHg.
2. The 3150R/3250R may be used with an optional in-bowl water probe or 200 watt, in-bowl heater (See accessories).
3. Allow at least 2 inches (51 mm) clearance under the units for replacement of element and water collection.
4. For additional information and availability, contact customer service at: (800) 344-3286, 6 AM to 5 PM, Pacific Time.

Specifications

BASIC MODELS		325R	330R	3150R	3250R
Maximum Flow Rate	GPH / LPH	60 / 227	75 / 284	150 / 568	250 / 946
Fuel Port Size		3/8"-18 NPTF (SAEJ476)	3/8"-18 NPTF (SAEJ476)	7/8"-14 SAE (SAEJ1926)	7/8"-14 SAE (SAEJ1926)
Service Filter Element Center Threads	SAE	S3225T or P 1"-14	S3226T or P 1"-14	S3238 1"-14	S3207 1"-14
Height	in. / mm	9.7/246	11/279	13.63/346	17.25/438
Width	in. / mm	4.4/112	4.4/112	5.00/127	5.00/127
Depth	in. / mm	4.8/122	4.8/122	5.5/140	5.50/140
Weight (dry)	Lbs. / kgs.	3.1/1.4	3.2/1.45	3.6/1.63	4.6/2.08
Clean Element Pressure Drop	PSI / kPa	0.17/1.2	0.39/ 2.7	.68/4.7	1.0/6.9
Max. Allowable Pressure	PSI / kPa	15/103	15/103	7/48	7/48
Bowl Water Capacity to probe tips (with heater)	ml	82 / 70	82 / 70	82 / 70	82 / 70
Operating Temperature		-40° / +255°F / -40° / +121°C			